

CALL FOR EXPRESSIONS OF INTEREST

PUBLIC ART OPPORTUNITY #4: lelám PLAZA GROUND PLANE PAVING DESIGN

Artwork Design

Musqueam Capital Corporation (MCC) invites Expressions of Interest from Musqueam artists and/or artist teams for an artwork design utilising the exterior ground plane pavers at 3 different site locations, within the lelám Village Square Plaza.

The artwork will reflect the thematic "*Musqueam Through Time: Past, Present, Future*" and traditional Coast Salish art elements, which can be open to interpretive art forms. Situated at the heart of the lelám development, in lelám's main social gathering space, the public art will promote social interaction and a sense of community, in this highly visible and accessible location. The ground plane pavers will provide strong placemaking and storytelling opportunities, fostering a uniquely Musqueam context.

ARTWORK BUDGET

1 artist and/or artist team will be selected for the public art opportunity, and will receive \$30,000 for their final artwork design and coordination work.

ELIGIBILITY

Open call to Musqueam artists and artist teams, including youth and elders, emerging, mid-career, and established artists and designers. Also suitable for a senior artist to lead an artist team. All individuals of a group or team must be Musqueam band members.

DEADLINE FOR EOI SUBMISSIONS

August 15, 2020 at 4pm

INQUIRIES

For questions, please contact:

Sara MacLellan
Ballard Fine Art
604.922.6843
sara@ballardfineart.com

Jan Ballard
Ballard Fine Art
604.612.6645
jan@ballardfineart.com

INTRODUCTION



Aerial view of Ielarn plaza, rendering

Unprecedented in scope and philosophy, Ielarn is a significant four-phased, 21.44-acre master-planned community within the University Endowment Lands (UEL). Adjacent to the University of British Columbia campus, the development sits to the west of the University Golf Club, fronting University Boulevard. Ielarn supports a diverse and inclusive mix of housing types, with a total of 1,250 homes for an estimated population of 2,500 residents. Thirty thousand square feet of commercial space add a vibrant mixed-use capability to the development, with a multitude of natural and built amenities on site, including restaurants and retail, as well as a community centre, daycare, and supermarket. The adjacent UBC campus is an historic, established, and robust community offering a wide array of additional amenities. Importantly, Ielarn is surrounded by 874 hectares of Pacific Spirit Park; hiking and walking trails, as well as nature preserves, cover over 63% of the site. Carefully integrating the development into its natural surroundings, Ielarn offers a lifestyle that is connected to nature.

Ielarn is a thoughtful reconsideration of modern day development, incorporating the ancient Musqueam values of interconnection through thinking, feeling, and experiencing. The three key design principles operate in line with this sentiment: Be Responsible, Be Inclusive, and Be Respectful.

PUBLIC ART OPPORTUNITY

PUBLIC ART OPPORTUNITY #4: lelərñ PLAZA GROUND PLANE PAVING TREATMENT

Artwork Design

- The selected Musqueam artist and/or artist team will work with the proposed exterior paving material, in collaboration with the lelərñ design team, to create an integrated artwork for the ground plane at the lelərñ Village Square plaza
- The 3 artwork design paving areas include the Ground Plane paving, Water Feature paving, and the Swordfern Trail paving
- MCC and the general contractor will be providing the ground plane paving material, which will be standard VS5 concrete paving stones in 3 different sizes, to allow for limitless design options
- Arrangement of pavers can be varied through the 4 available standard lelərñ colours which are grey, dark grey, charcoal and desert buff
- The artwork will reflect the thematic *"Musqueam Through Time: Past, Present, Future"*
- The artwork will reflect traditional Coast Salish art elements, which can be open to interpretive art forms, and could reference weaving patterns
- Site restrictions and conditions, including potential ground plane location areas and dimensions, material specifications and colours, will be confirmed at the artist orientation meeting

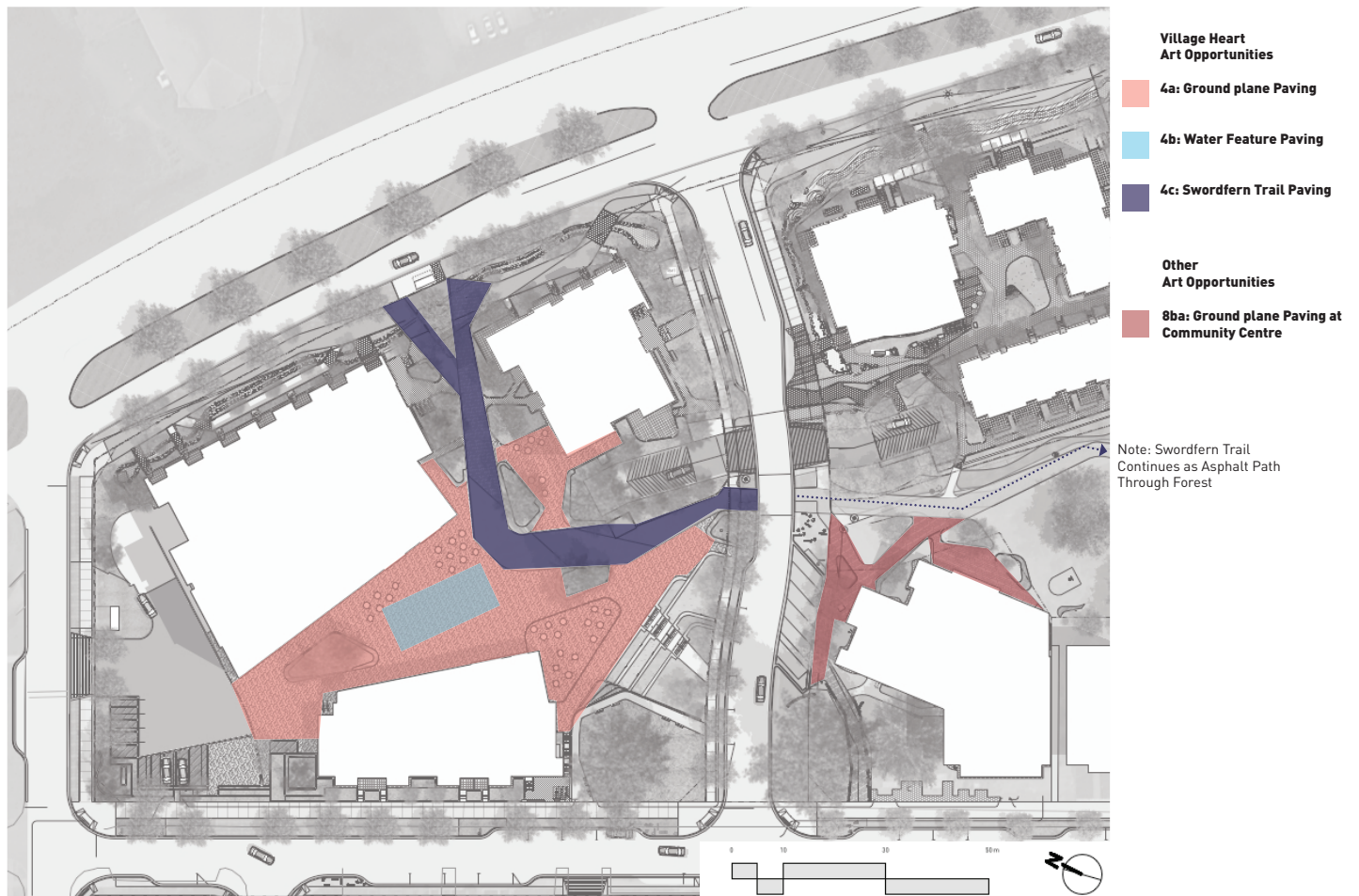

Rendering of lelərñ plaza ground plane paving art opportunities

Water Feature Area:

- The water feature area (splash park) is at the centre of the Ielarn Plaza. Water can be shut off seasonally or for events, creating an open flexible hard surface plaza space
- The water jets are configured within a rectangular perimeter, measuring 63ft 6in by 28ft (165ft²)
- The water feature contains 25 water jets in the paving, and the program of the features can be specified by the artist
- It is important to note the sleeve locations of the waterjets are fixed as per the below landscape plan. However, there is an opportunity to "design" and place the jet locations within a limited radius of the pre-set water jet sleeve location
- The selected artist will work jointly with the water feature designer and landscape architect to confirm the exact water jet locations, and technical considerations
- Paving within the water feature perimeter is to be local BC stone mortared in place. The stone surface must be non-slip to meet the Vancouver Coastal Health requirements. Basalt, Granite and Marble have been used successfully in similar water features
- Arrangement of the paving stones can be varied through the standard Ielarn colours
- Stone paving can extend beyond the water feature perimeter if desirable for the art design

Swordfern Trail Area:

- The Swordfern Trail links all of the important community amenities in the Ielarn development, including the Forest Park, Village Square and new bus stop on University Boulevard
- The public art pavers will occur where the Swordfern Trail crosses the public plaza, where it will have an urban expression reflective of the overarching plaza design
- The paving pattern will identify the Swordfern Trail

For further reference, please see the development design guidelines that are available for download from UEL: http://www.universityendowmentlands.gov.bc.ca/library/_Block%20F%20Design%20Guidelines.pdf

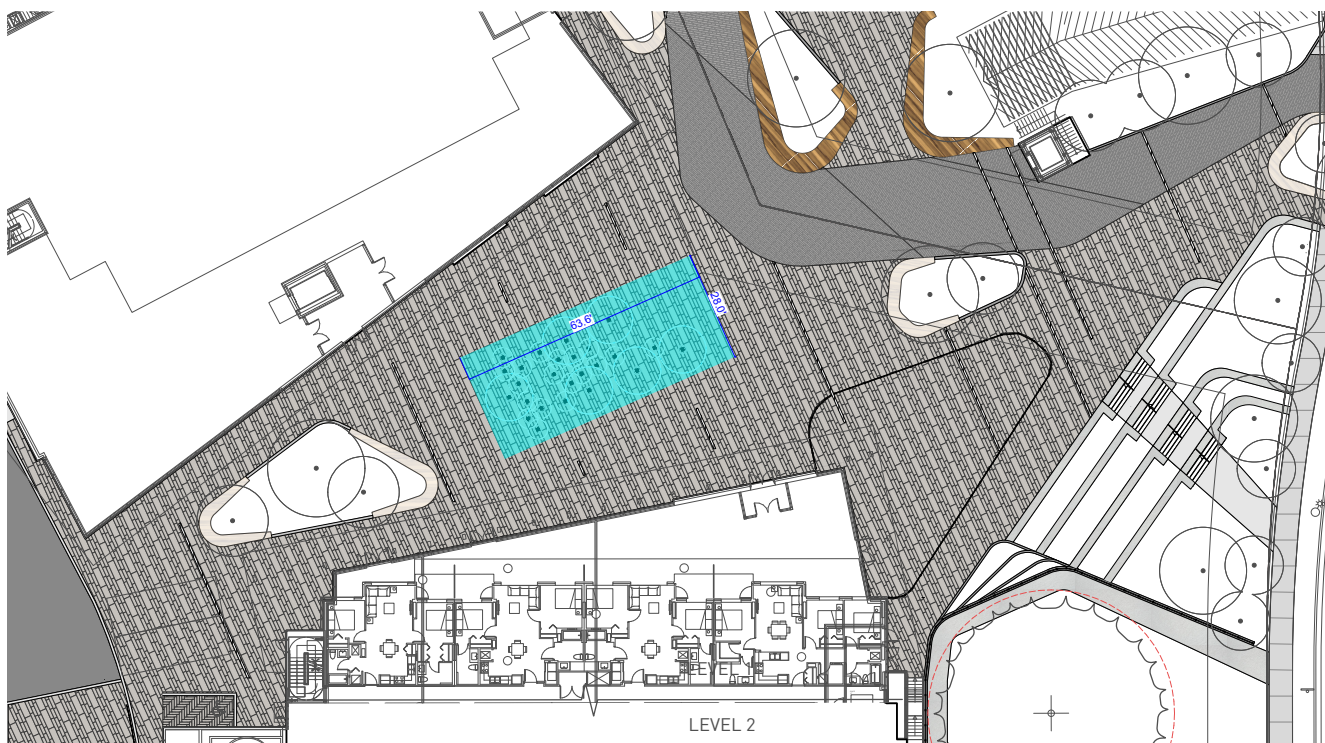

Rendering of Ielarn plaza water feature shown in blue, waterjet sleeve locations shown in black dots

PUBLIC ART SITE LOCATION



Site plan showing approximate site location for public art opportunity within Ielarn

- * Public Art Opportunity #4 - Ielarn Plaza Exterior Paving Design (includes the plaza Ground Plane paving, Water Feature paving, and the Swordfern Trail paving)

THEME

Musqueam Through Time: Past, Present, Future

The theme for the Public Art Master Plan at Ielə́m is *Musqueam Through Time*, engaging not only with our past, but also the present and looking forward to the future. The artworks, created by Musqueam artists, will give substance to this new community.

Musqueam is a strong and flourishing community with over a thousand members maintaining strong traditional and cultural beliefs. Conventionally, we used the resources the land provided for fishing, hunting, trapping and gathering to maintain our livelihood. Today, we continue to use these resources for economic and traditional purposes.

We continue to honour our collective responsibilities by keeping our culture alive and strong, and by being the stewards of our land. Our historians and educators pass on Musqueam history to the next generation. This has always been our way. We are of one heart, one mind that honours our land. The land exists as a memorial for ancestors and as a promise of security for future generations. These laws are our history; they make up the foundations of our present and our future success.

Ielə́m is on land that we have occupied for thousands of years. It is imbued with the soul of our people and is alive with the stories of our past. At Ielə́m, MCC seeks to preserve this incredible landscape, and to honour it by weaving artwork throughout the space. Ielə́m is a progressive new community. It is a careful reconsideration of modern day development incorporating Musqueam values, teachings and laws to protect our environment and build a genuine community for all. To consciously create something that changes the way we experience life. Connection to nature, an enriched sense of community, and a living relationship with ancestry guide our way of life, and have informed the conception of this very special community.

Ielə́m is not only a new community but is also a respectful, inclusive way to live. People from all walks of life will experience the meaning of home at Ielə́m, surrounded by nature and Musqueam artworks.

EOI SUBMISSION INFORMATION & REQUIREMENTS

ARTWORK BUDGET

The artwork budget for the Ielām Plaza Ground Plane Pavers is \$30,000 which includes the artwork design, artist or artist team fee, and design coordination work with the Ielām project team. If an artist team is selected, the "team" will receive the designated public art budget.

The artist will work with the proposed paving material for the ground plane for an integrated approach. The base costs of the proposed paving material are not part of the artwork budget. However, the artwork design and its coordination are considered a premium over and above the base costs of the paving material and are considered part of the public art budget and fall under the responsibility of the artist.

TARGET PUBLIC ART TIMELINE

Expression of Interest Submission Deadline	August 15, 2020
Artists Shortlisted	September, 2020
Shortlisted Artist Orientation Meeting	September, 2020
Shortlisted Artist Concept Proposal Presentations	November, 2020
Final Artist Selected	November, 2020
Artwork Completion	Summer 2021 (Target)

EXPRESSION OF INTEREST SUBMISSION REQUIREMENTS

- i. Written artist statement (50-200 words) outlining their proposed approach and ideas for the paving design. May include copies of sketches or digital renderings
- ii. Images of previous work (up to 5 images). Digital images should be no more than 2MB each. Please do not submit original artworks
- iii. Complete artist contact information

EXPRESSION OF INTEREST SUBMISSION DEADLINE: AUGUST 15, 2020 at 4PM

Submissions may be emailed, mailed, or hand delivered. Please note that hard-copy submissions will not be returned to artists.

Email EOI submissions to:

Sara MacLellan, Public Art Project Manager
Ballard Fine Art
Email: sara@ballardfineart.com
Jan Ballard Cell: 604.612.6645

Hand deliver to:

Musqueam Capital Corporation
Attn: Desirae Fraser
202-5704 Balsam Street
Vancouver, BC V6M 4B9

ARTIST SELECTION PROCESS

The final artist selection will be chosen by a selection panel consisting of representatives from the Ielarn Art Committee. The process will be facilitated by professional art consultants Ballard Fine Art Ltd.

The selection panel will review all Expression of Interest (EOI) submissions and shortlist artists and/or artist teams to develop a concept proposal for the public art opportunity. The shortlisted artists and/or artist teams will be invited to attend an artist orientation meeting with the Ielarn design team.

Each shortlisted artist and/or artist team will be paid an **honorarium of \$1,500** for their concept proposal, paid upon receipt and presentation of the concept proposal. The honorariums are separate from the designated artwork budget.

Following the selection panel's review of the shortlisted artist concept proposals, a final artist or artist team will be selected for the public art opportunity. The final artist or artist team selected will be awarded a contract of \$30,000 to complete the artwork design commission.